

# OPERATING MANUAL

## 1110WH - 1~10V dimmable

Important: Please read the instruction manual carefully prior to installation and keep it for future reference.

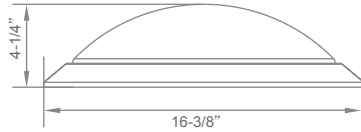

Ordering code	Power(W)	Function Description
1110WH	28	1~10V dimmable

Mounting: Wall or Ceiling  
 Light features:  
 CRI(Ra): 90Ra  
 Life Time: 50,000hrs  
 Light Source: LED SMD2835  
 Input:100-277VAC 50/60Hz

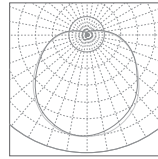

C0/C180 — C90/C270

### Accessories

No.	Pic.	Qty.	Usage
1		2	Machine screw
2		3	Cap for wire connection

### Color temperature code:

Code	Color temperature	CCT(K)	Lumen
30K	Warm White	3000	1656

### Installation:

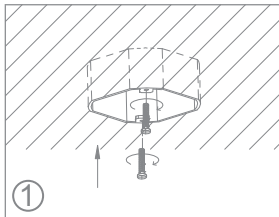

Machine screws are driven into junction box's tapped holes.

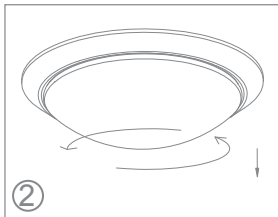

Remove the cover.

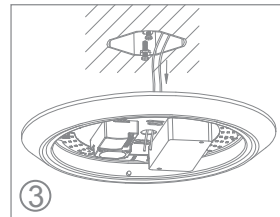

Power cord comes into the fixture.

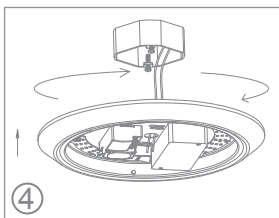

Fixture is fixed onto junction box.

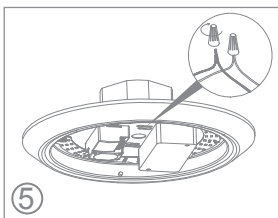

Wire connection.

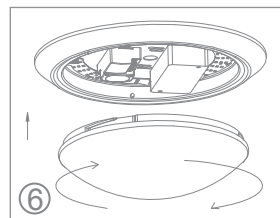

Close the cover.

# OPERATING MANUAL

## 1110WH - 1~10V dimmable

Important: Please read the instruction manual carefully prior to installation and keep it for future reference.

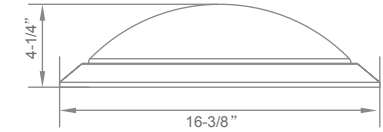

Ordering code	Power(W)	Function Description
1110WH	28	1~10V dimmable

Mounting: Wall or Ceiling  
 Light features:  
 CRI(Ra): 90Ra  
 Life Time: 50,000hrs  
 Light Source: LED SMD2835  
 Input:100-277VAC 50/60Hz

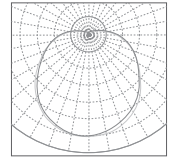

C0/C180 — C90/C270

### Accessories

No.	Pic.	Qty.	Usage
1		2	Machine screw
2		3	Cap for wire connection

### Color temperature code:

Code	Color temperature	CCT(K)	Lumen
30K	Warm White	3000	1656

### Installation:

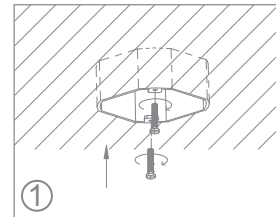

Machine screws are driven into junction box's tapped holes.

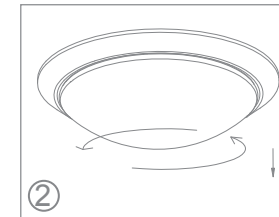

Remove the cover.

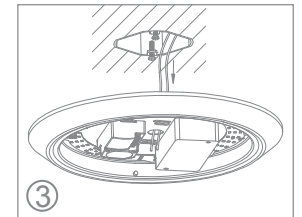

Power cord comes into the fixture.

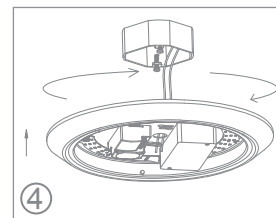

Fixture is fixed onto junction box.

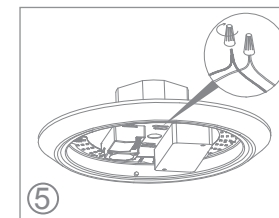

Wire connection.

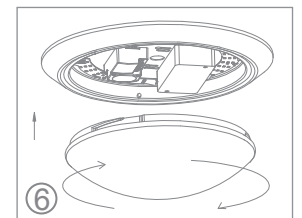

Close the cover.

### Detection Pattern

ceiling mounting pattern (m)

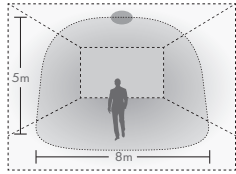

wall mounting pattern (m)

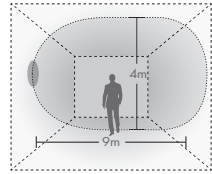

### Maintenance

1. Cut off the main power first
2. Don't touch LEDs while maintaining or cleaning
3. Don't use chemicals to clean the fixture.

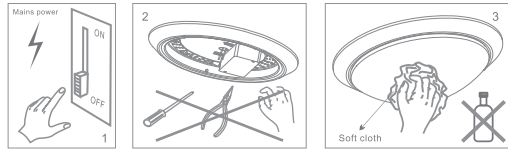

Environmental protection: waste electrical products should not be disposed of with household waste. Please recycle where facilities exist. Check with your local authority or retailer for recycling advice.



### Caution:

1. Warning – Risk of fire or electric shock. This product requires knowledge of luminaires electrical systems. If not qualified, do not attempt installation. Contact a qualified electrician.
2. Warning – To prevent wiring damage or abrasion, do not expose wiring to edges of sheet metal or other sharp objects.
3. Warning – Do not touch LED chips while installing or maintaining, any damage occurred during installation or maintaining is not covered by warranty.
4. Warning – Assure the branch electrical circuit breaker or switch is off before installing.

### Detection Pattern

ceiling mounting pattern (m)

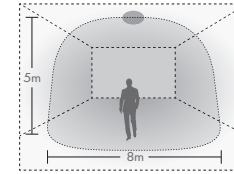

wall mounting pattern (m)

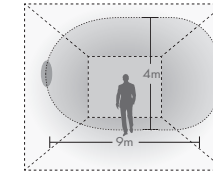

### Maintenance

1. Cut off the main power first
2. Don't touch LEDs while maintaining or cleaning
3. Don't use chemicals to clean the fixture.

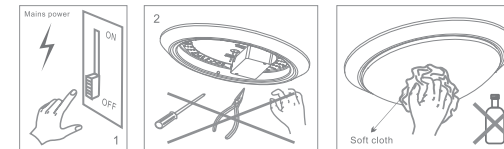

Environmental protection: waste electrical products should not be disposed of with household waste. Please recycle where facilities exist. Check with your local authority or retailer for recycling advice.



### Caution:

1. Warning – Risk of fire or electric shock. This product requires knowledge of luminaires electrical systems. If not qualified, do not attempt installation. Contact a qualified electrician.
2. Warning – To prevent wiring damage or abrasion, do not expose wiring to edges of sheet metal or other sharp objects.
3. Warning – Do not touch LED chips while installing or maintaining, any damage occurred during installation or maintaining is not covered by warranty.
4. Warning – Assure the branch electrical circuit breaker or switch is off before installing.

